

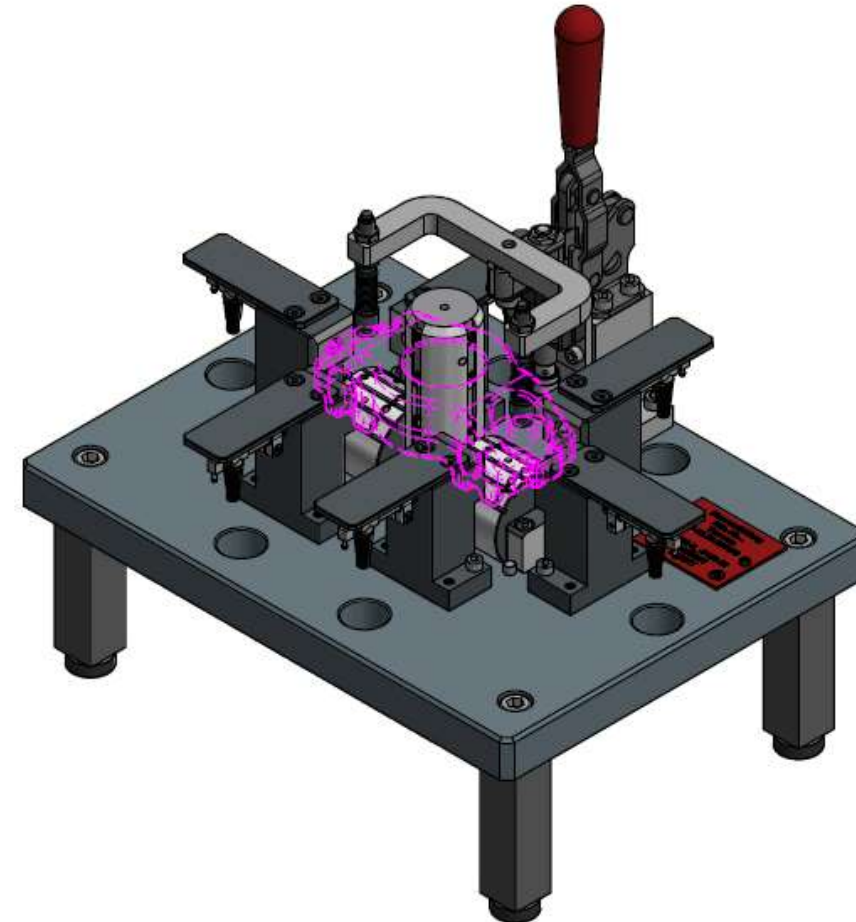

SPC-Messplatz Bremstraverse

Spanner geöffnet

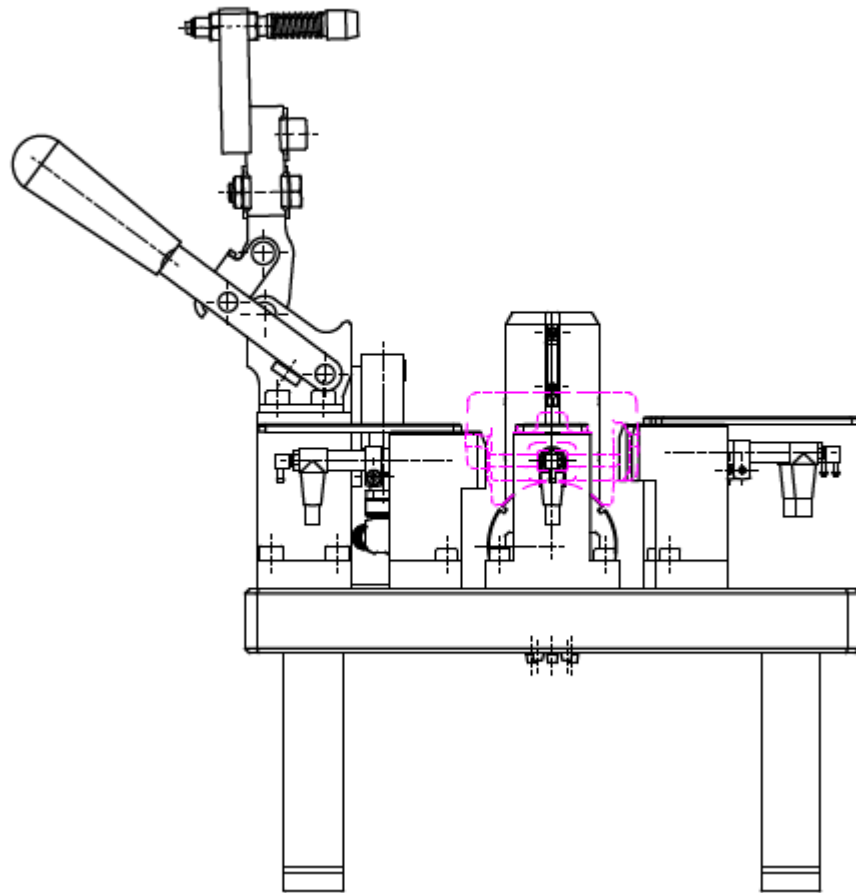

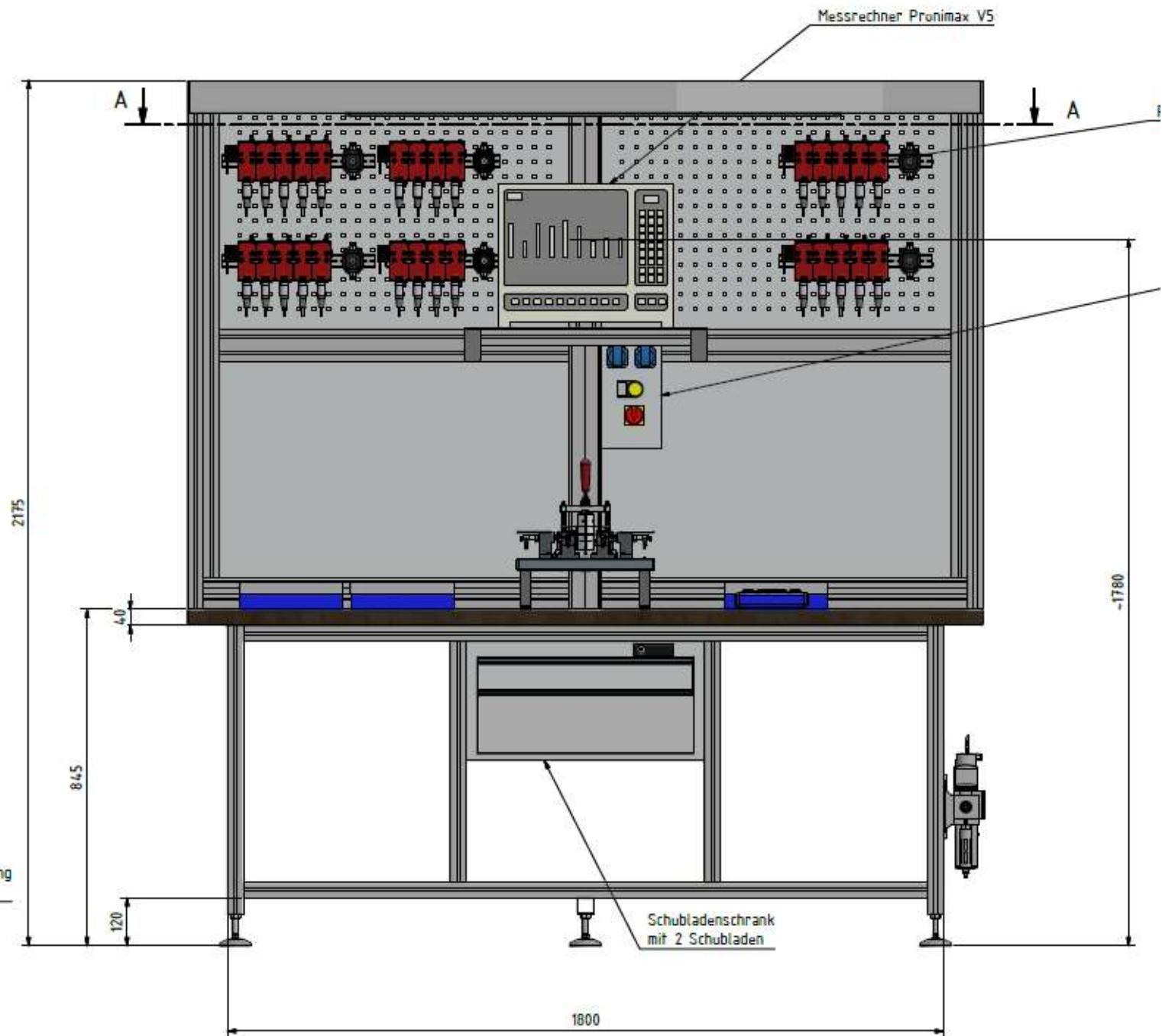
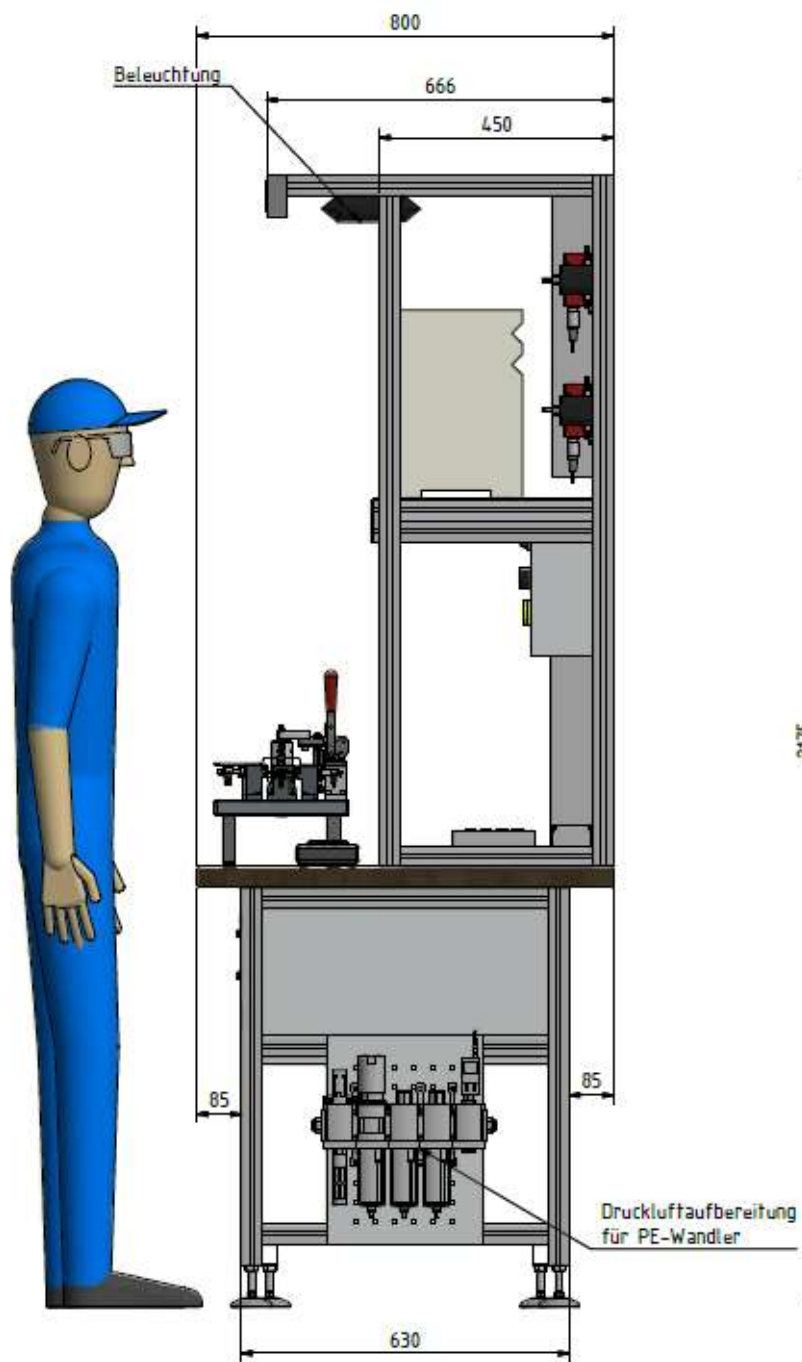

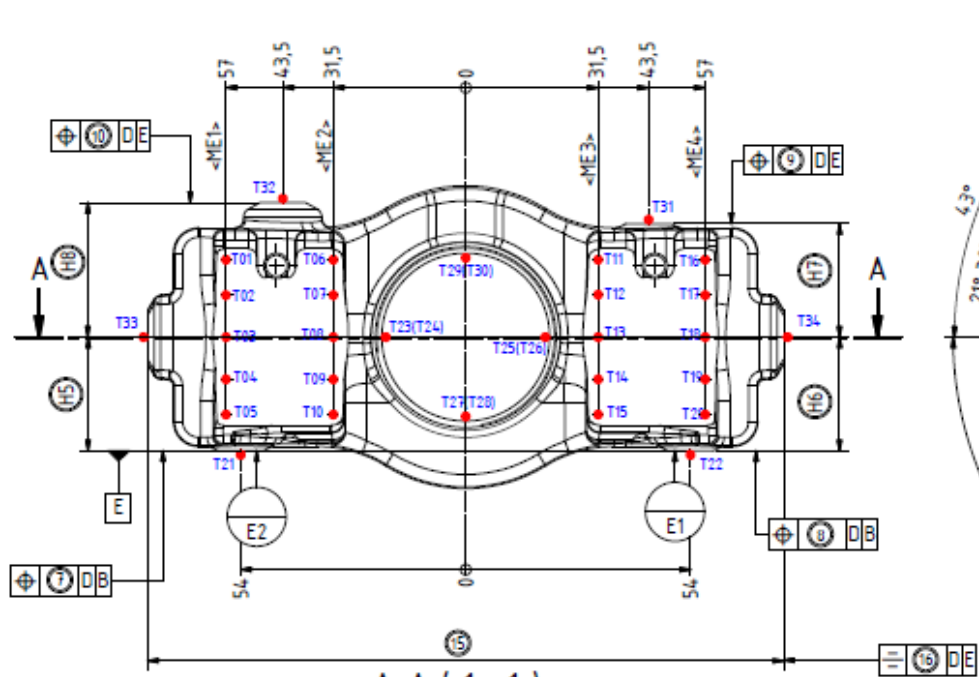

A-A (1:1)

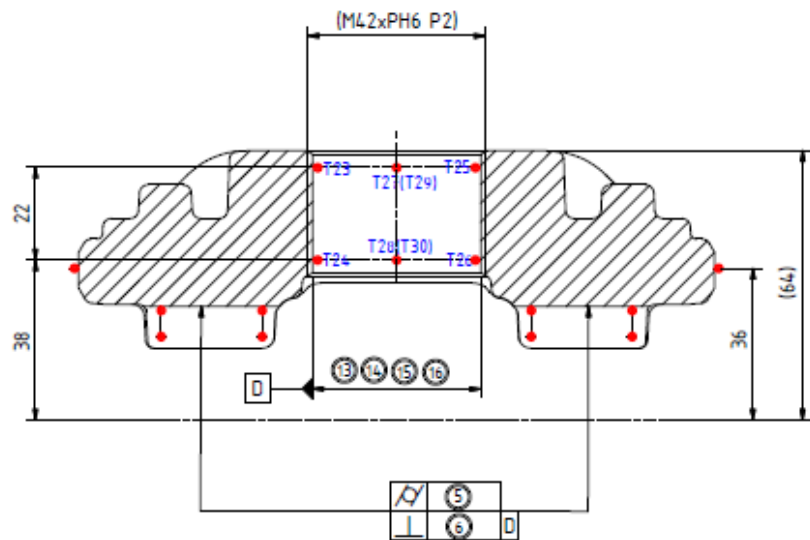
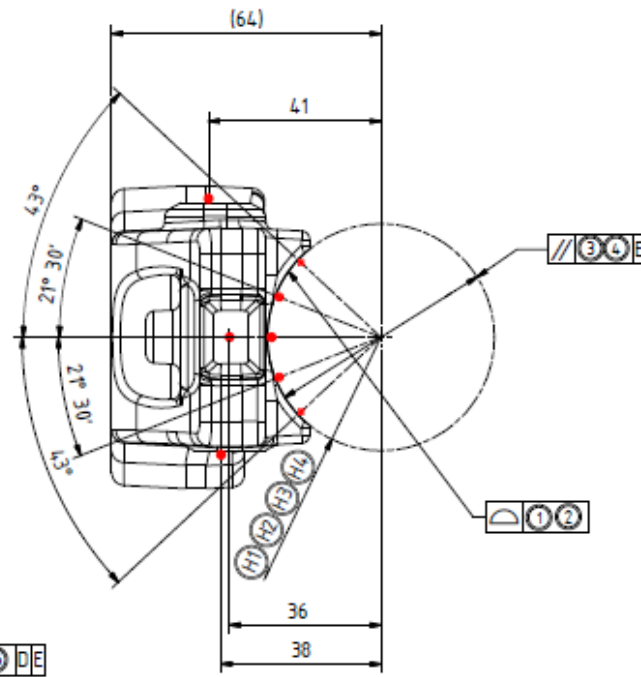

Nr.	Merkmal	Dimension	Auswertung
1	Profil	0,037 UZ-0,0185	T01-T10
2	Profil	0,037 UZ-0,0185	T11-T20
3	Parallelität zu E	0,2 CZ	T21, T22 [T01-T10]
4	Parallelität zu E	0,2 CZ	T21, T22 [T11-T20]
5	Zylinderform	0,04 CZ	T01-T20
6	Rechtwinkligkeit zu D	0,1 CZ	T23-T26 [T01-T20]
7	Position zu DB	0,2	T21 [T27 - T30]
8	Position zu DB	0,2	T22 [T27 - T30]
9	Position zu DE	0,2	T31 [T27 - T30]
10	Position zu DE	0,2	T32 [T27 - T30]
11	Abstand	151,25 -0,2	T33, T34
12	Symmetrie zu DE	0,4	T33, T34 [T23 - T26]
13	Kernlochdurchmesser	$\varnothing 39,934 \pm 0,1$	T23, T25
14	Kernlochdurchmesser	$\varnothing 39,934 \pm 0,1$	T27, T29
15	Kernlochdurchmesser	$\varnothing 39,934 \pm 0,1$	T24, T26
16	Kernlochdurchmesser	$\varnothing 39,934 \pm 0,1$	T28, T30
H1	Radius	27 (+0,037)	T01, T03, T05
H2	Radius	27 (+0,037)	T06, T08, T10
H3	Radius	27 (+0,037)	T11, T13, T15
H4	Radius	27 (+0,037)	T16, T18, T20
H5	Abstand	27 ($\pm 0,1$)	T21 [T27 - T30]
H6	Abstand	27 ($\pm 0,1$)	T22 [T27 - T30]
H7	Abstand	27 ($\pm 0,1$)	T31 [T27 - T30]
H8	Abstand	32 ($\pm 0,1$)	T32 [T27 - T30]



SPC-Messplatz Bremshebel

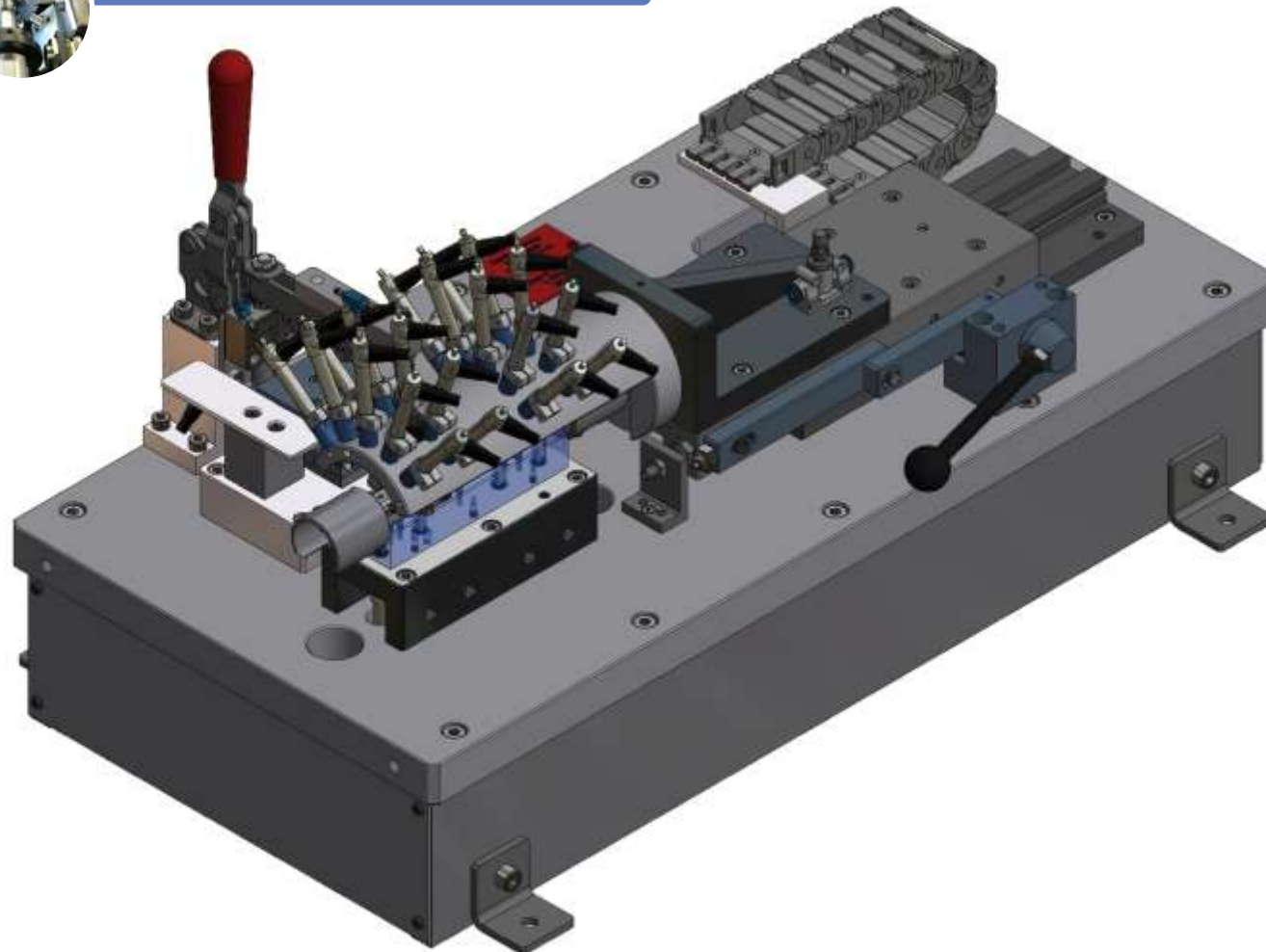



SPC-Messplatz Bremshebel

PRÜFGRUND:	FERTIGTEILPRÜFUNG
MESSEN:	KALOTTE HALBSCHALE AUßENKONTUR BOHRUNGSDURCHMESSER
MERKMALE:	RADIUS RADIENFORM ZYLINDERFORM POSITION DISTANZ DURCHMESSER PARALLELITÄT RECHTWINKLIGKEIT SYMMETRIE BREITE

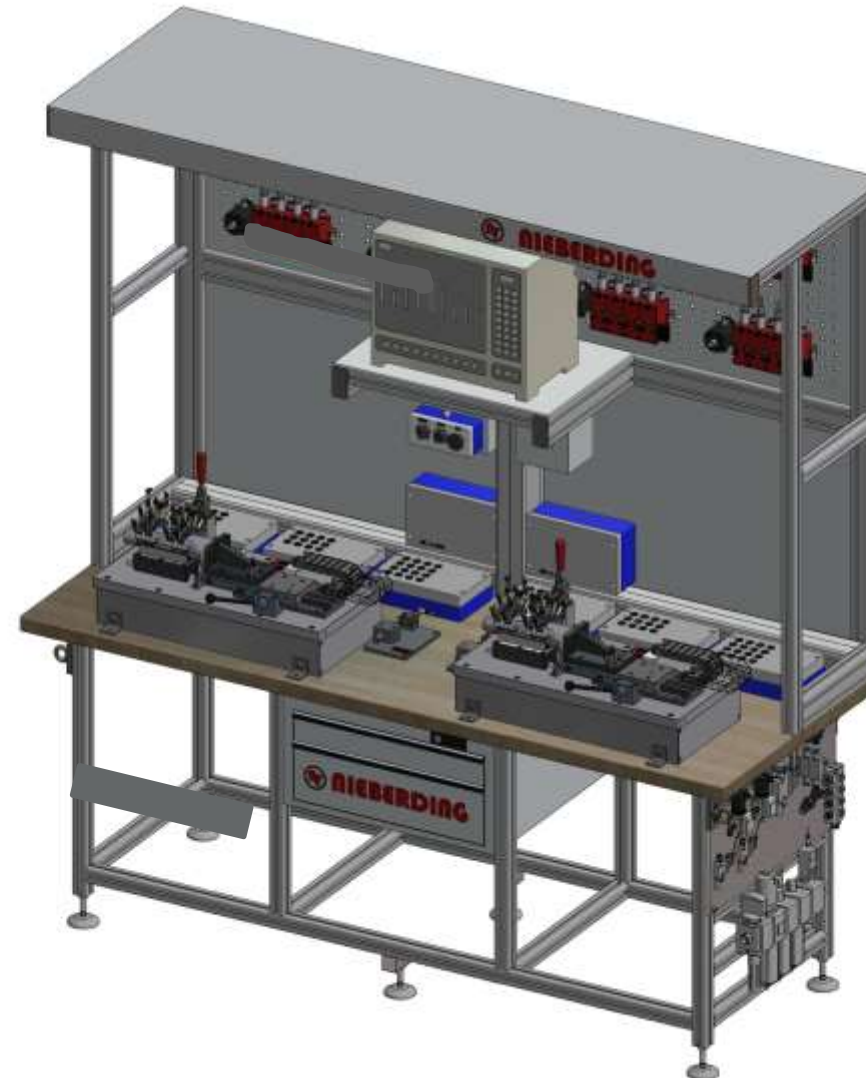



SPC-Messplatz Kreuzgelenkgabel

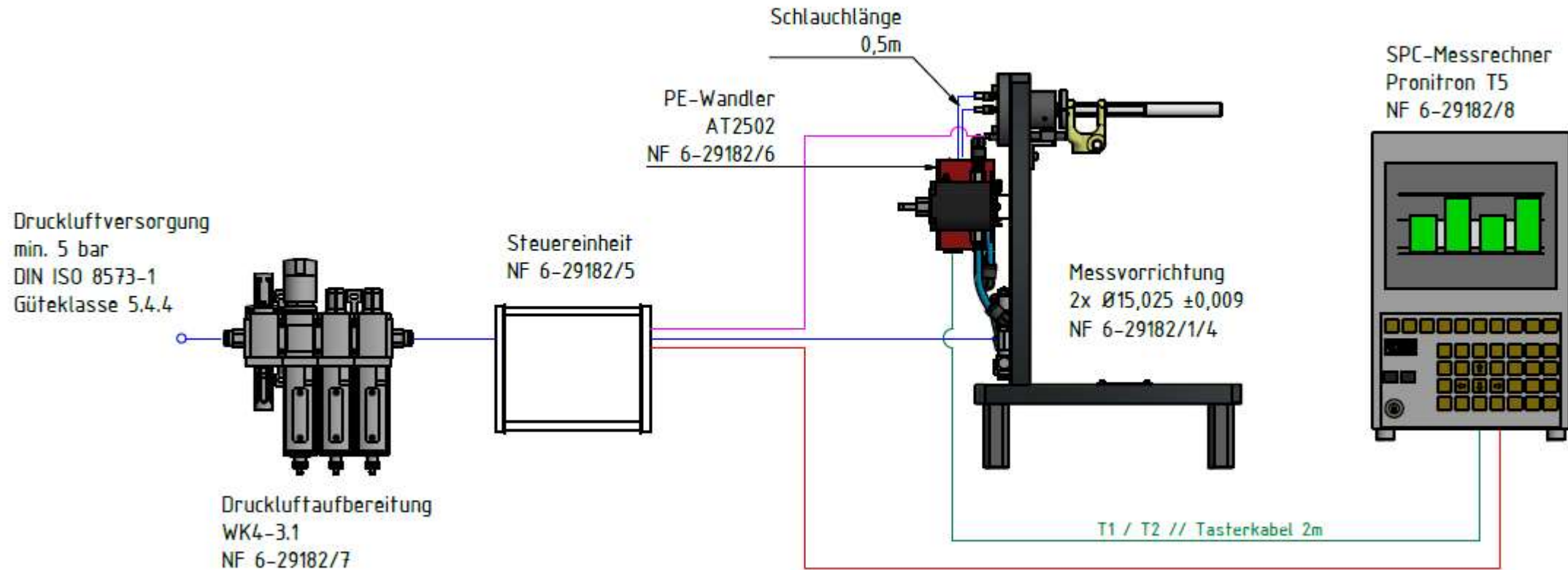



SPC-Messplatz Ventilplatten

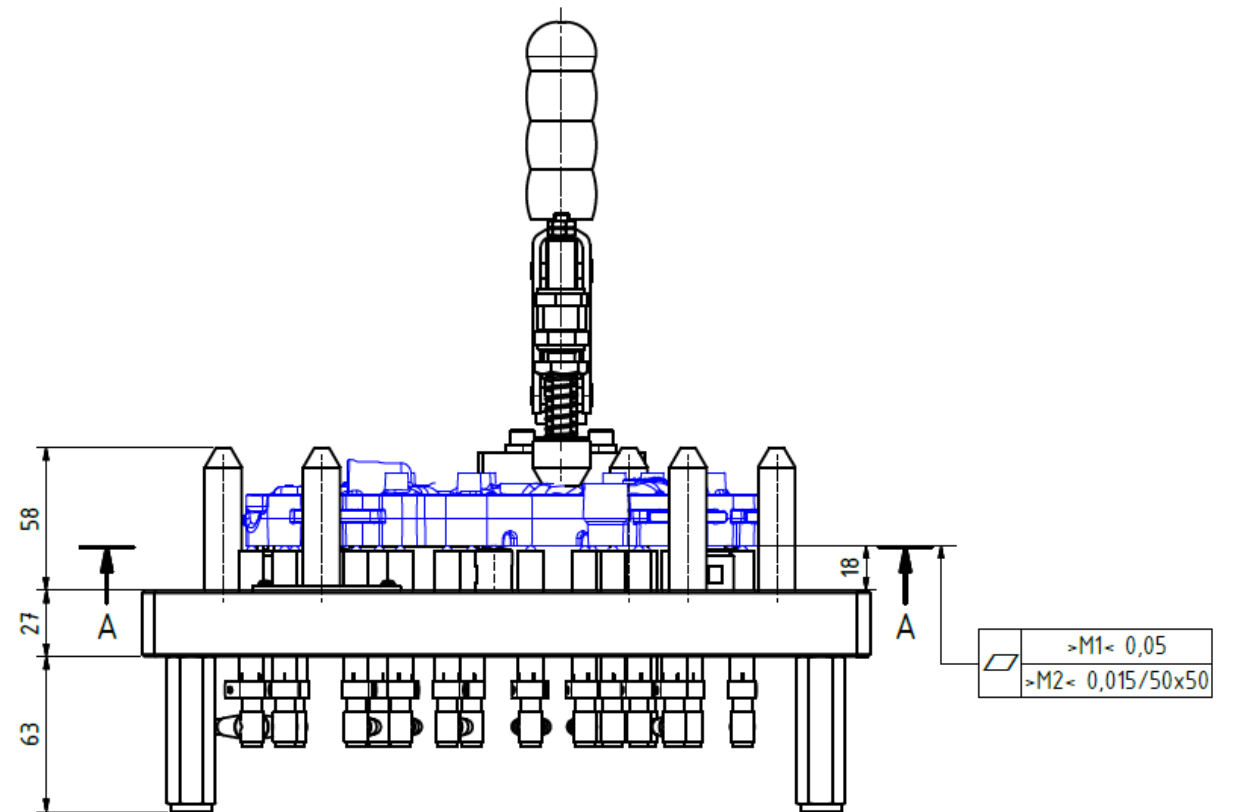
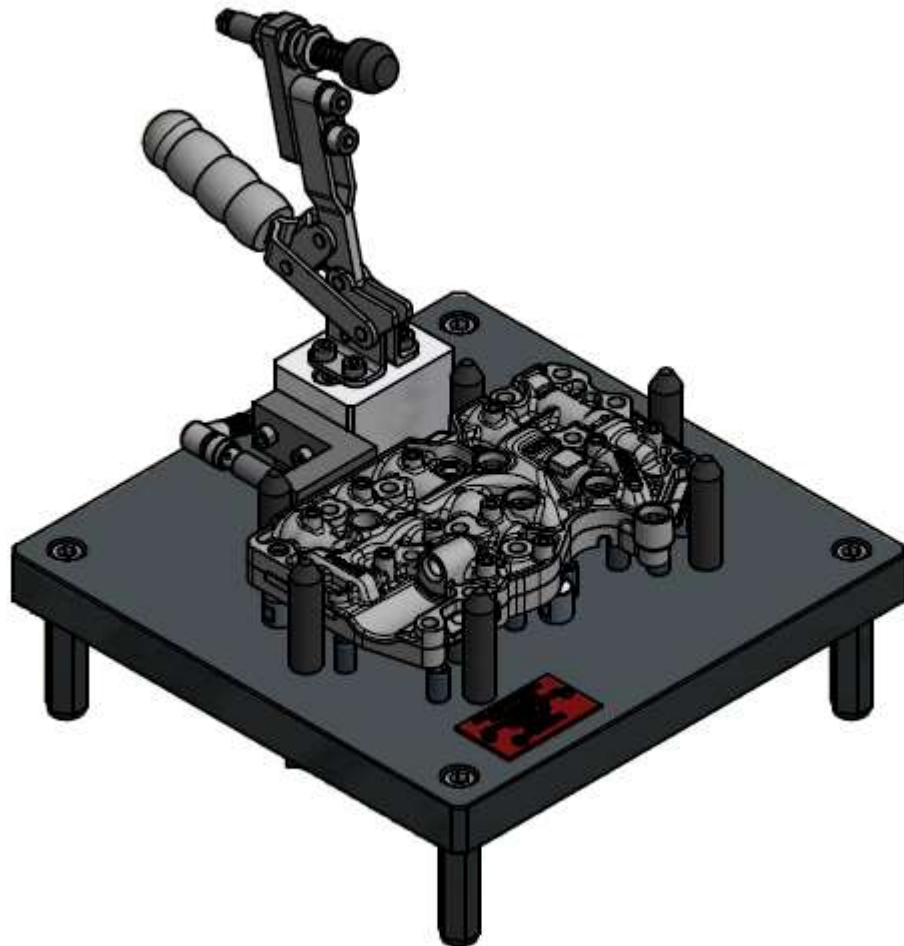

APPROVAL DRAWING

MEASURING CHARACTER	DIMENSION	EVALUATION
1	Flatness	0,050
2	Flatness	0,015 / 50x50

Specification for evaluation of measuring task required.

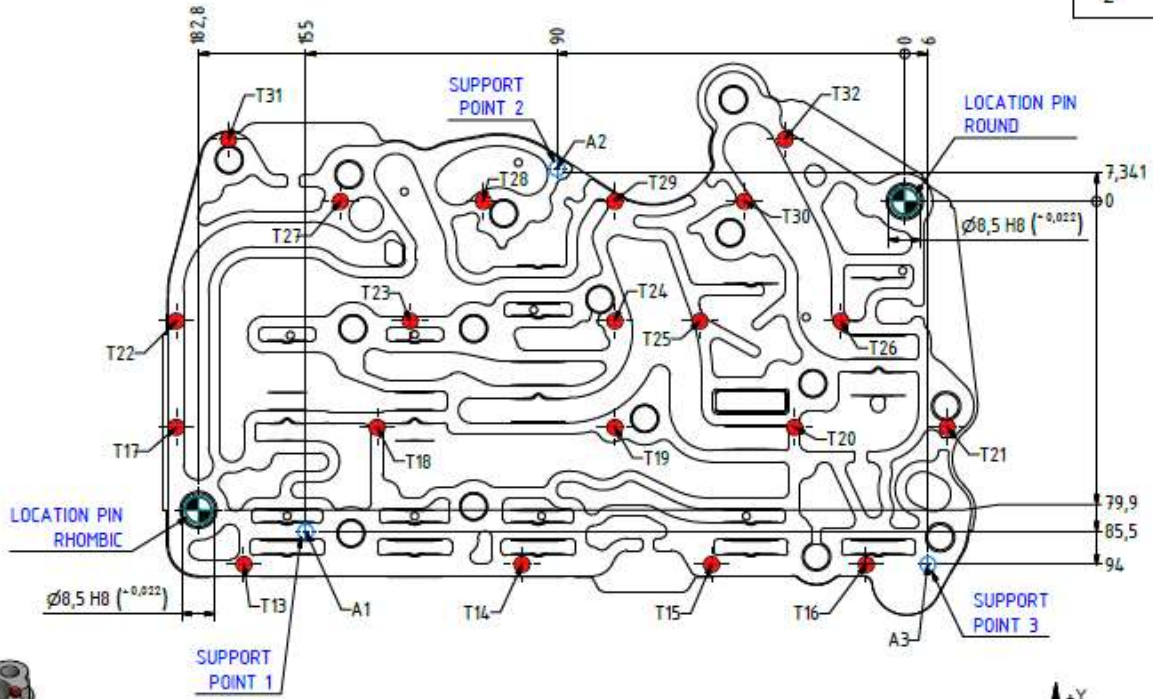

MEASURING POINTS		
PROBE NO.	X-ABM.	Y-ABM.
T13	-171,00	-94,00
T14	-99,00	-94,00
T15	-50,00	-94,00
T16	-10,00	-94,00
T17	-188,50	-58,50
T18	-136,50	-58,50
T19	-75,00	-58,50
T20	-28,50	-58,50
T21	11,00	-58,50
T22	-188,50	-31,00
T23	-128,00	-31,00
T24	-75,00	-31,00
T25	-53,00	-31,00
T26	-16,50	-31,00
T27	-146,00	0,00
T28	-109,00	0,00
T29	-75,00	0,00
T30	-41,50	0,00
T31	-175,00	16,00
T32	-31,00	16,00

SUPPORT POINTS		
SUPPORT	X-ABM.	Y-ABM.
A1	-155,00	-85,50
A2	-90,00	8,50
A3	6,00	-94,00

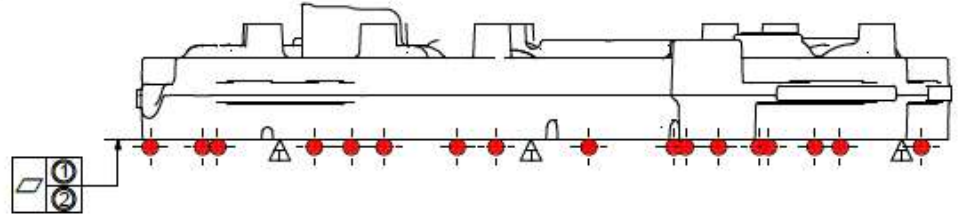
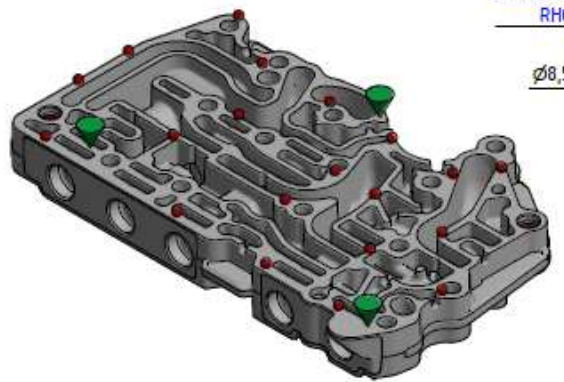
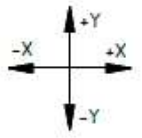

- Clamping point
- Support
- Measuring point

Dimensioning abbreviation	
Shortcut	Meaning
P/P	Workpiece dimension
>Mx<	Measuring character
<MEx>	Measuring level
Txx	Probe no./ channel



SPC-Messplatz Ventilplatten





SPC-Messplatz Ventilplatten

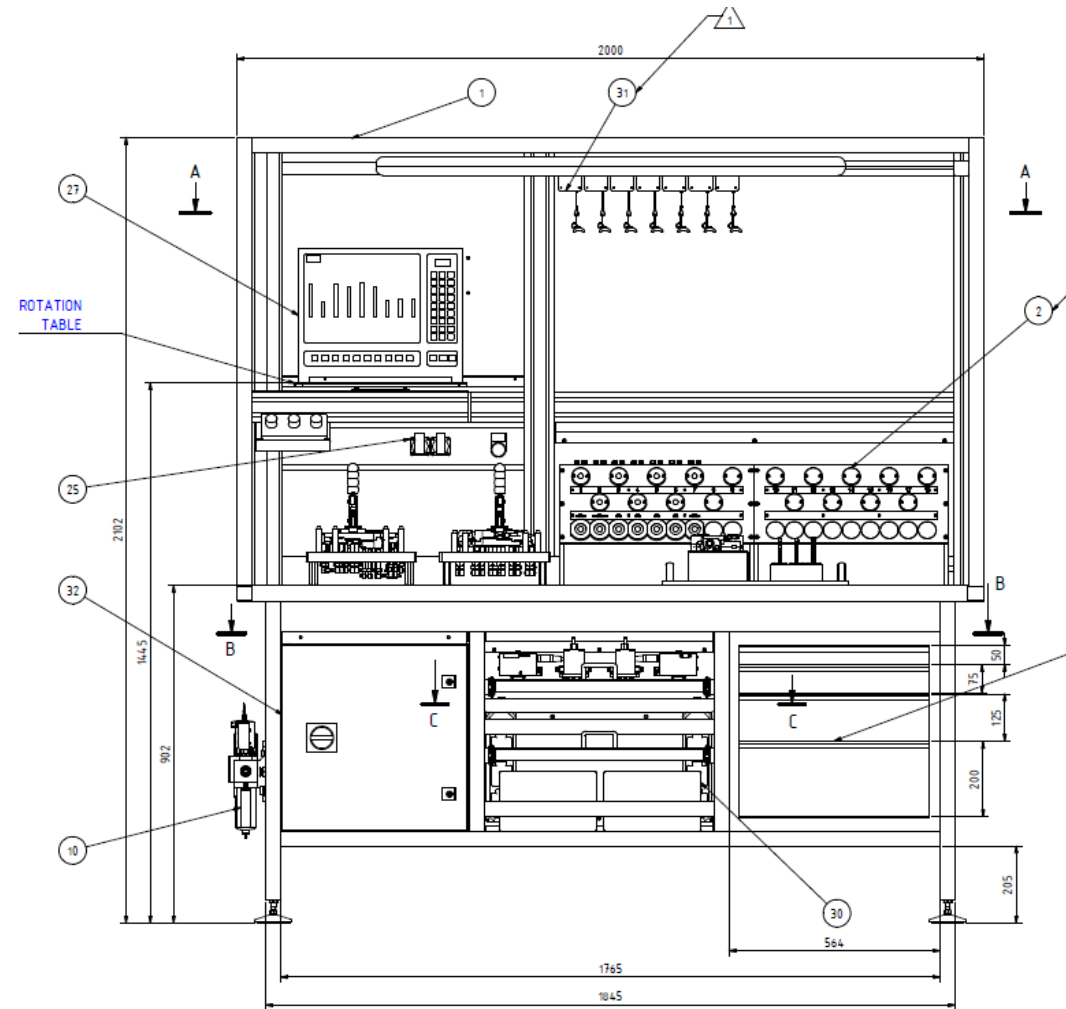
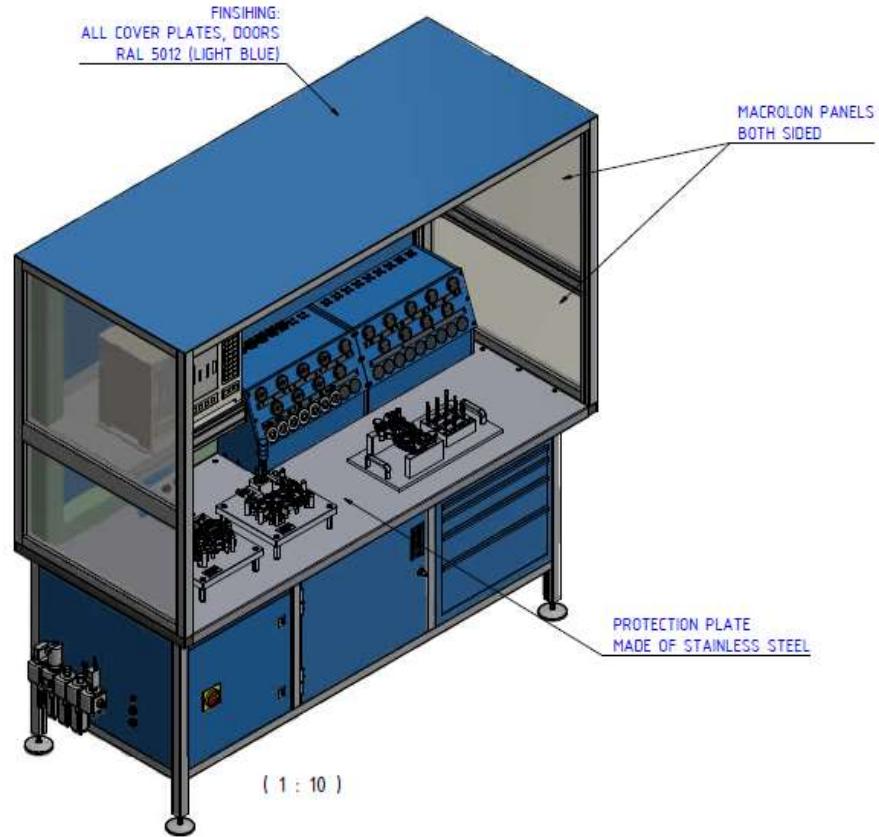



SPC-Messplatz Ventilplatten

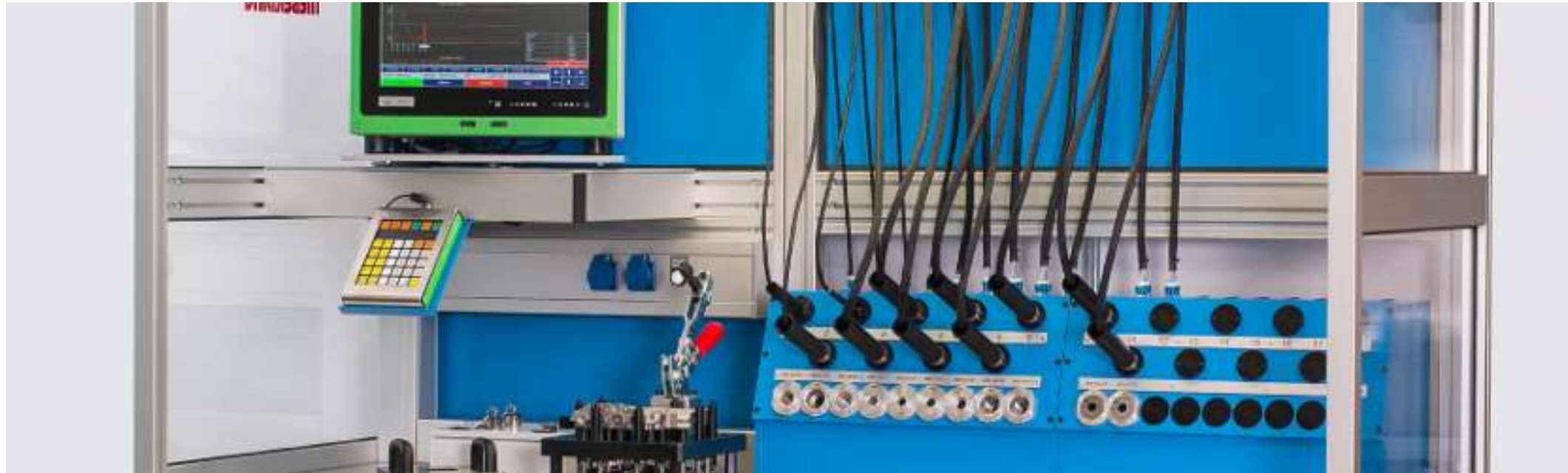



SPC-Messplatz Ventilplatten





SPC-Messplatz Pleuel

- Durchmesser in mehreren Messebenen
- Rundheit, Verbiegung
- Verdrehung und Achsabstand
- Wechselsätze für 9 Typen

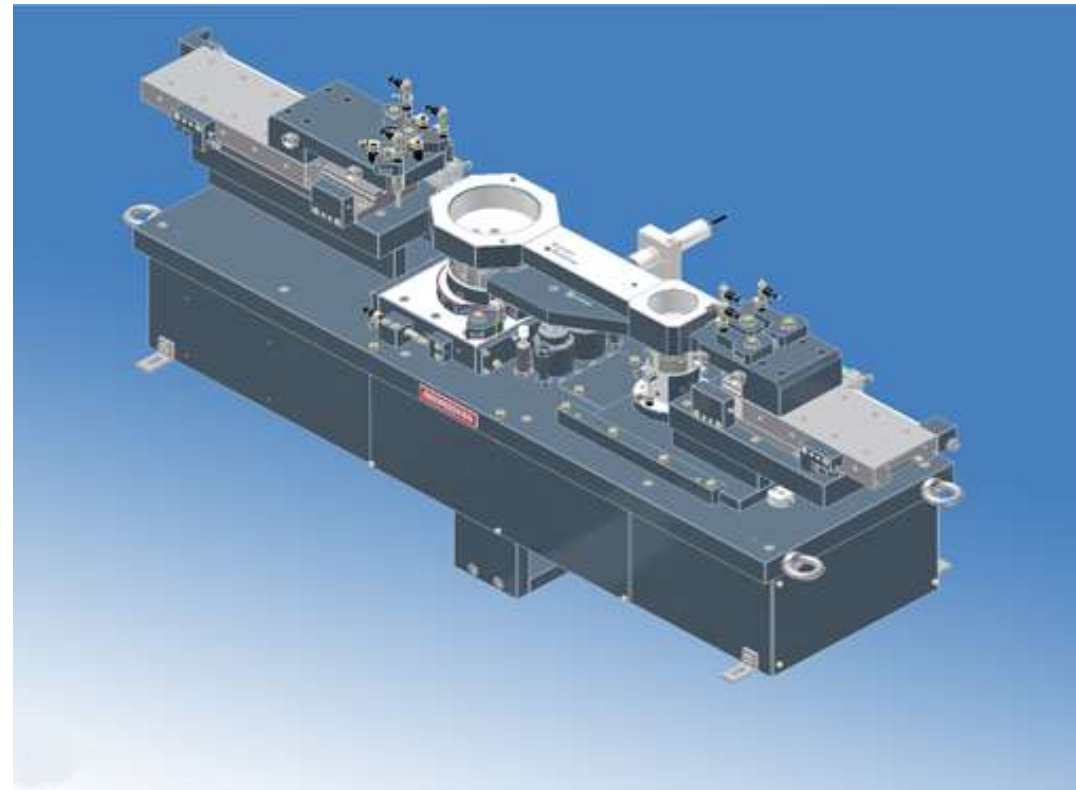



SPC-Messplatz Pleuel

- Durchmesser in mehreren Messebenen
- Rundheit, Verbiegung
- Verdrehung und Achsabstand
- Wechselsätze für 9 Typen (farblich markiert)





SPC-Messplatz Pleuel

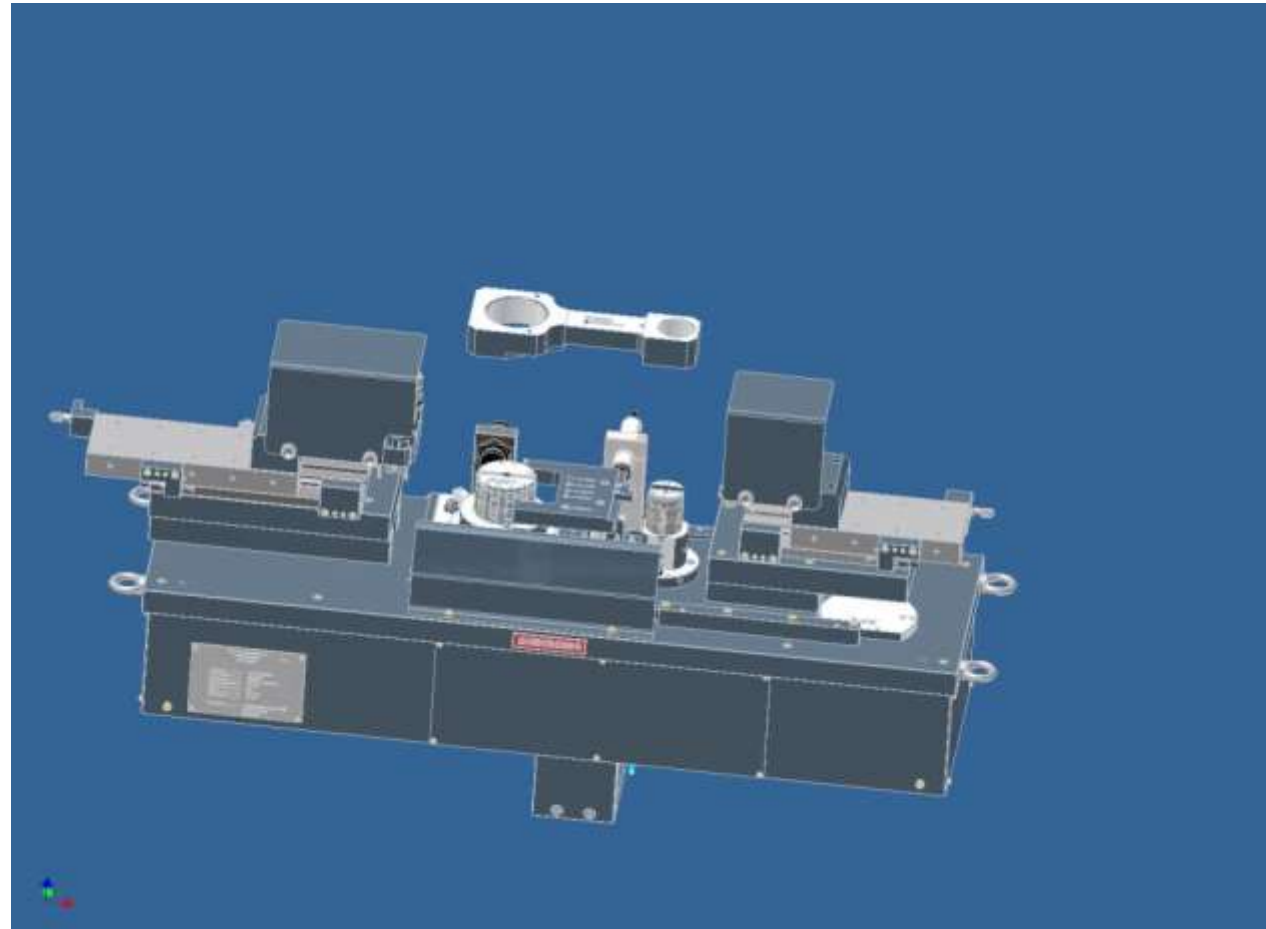



SPC-Messplatz Pleuel

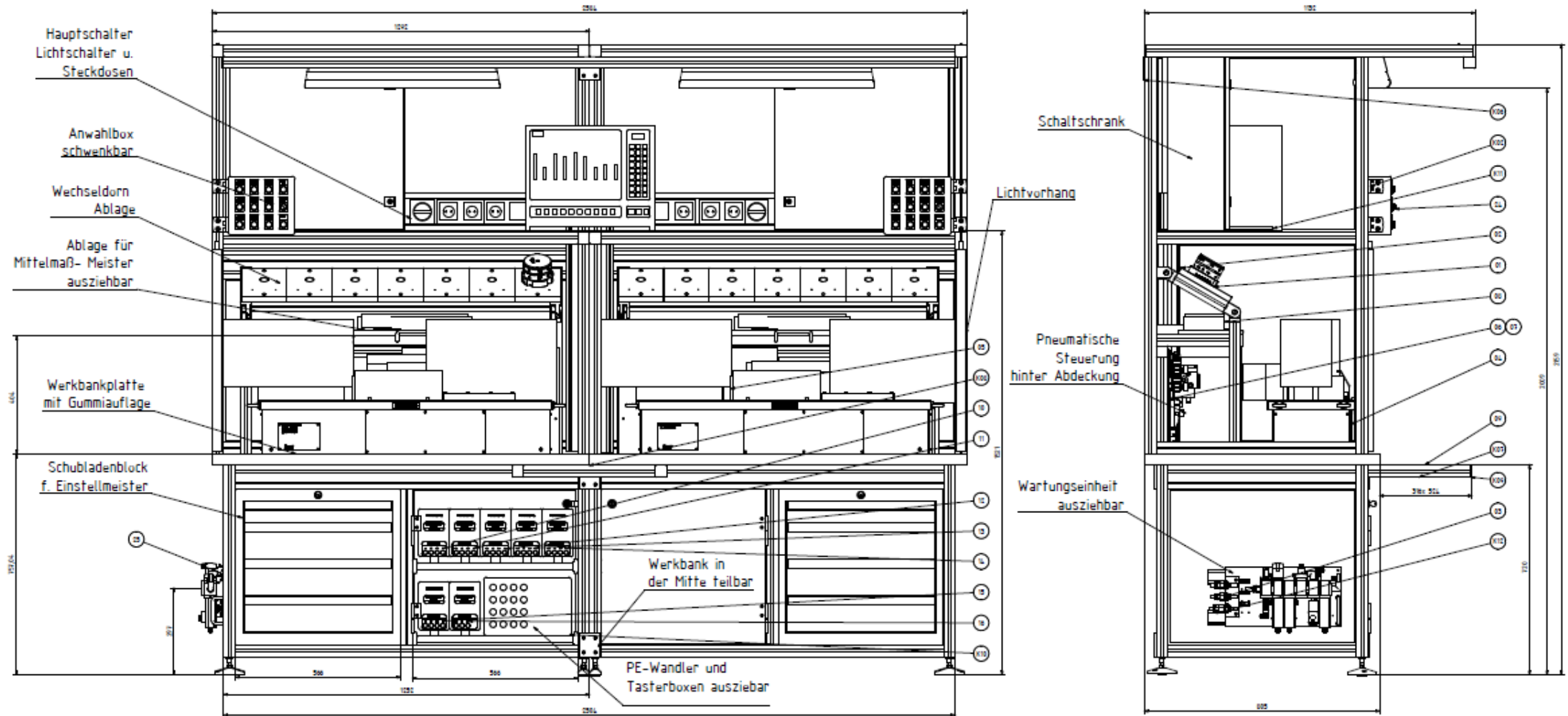



SPC-Messplatz Pleuel

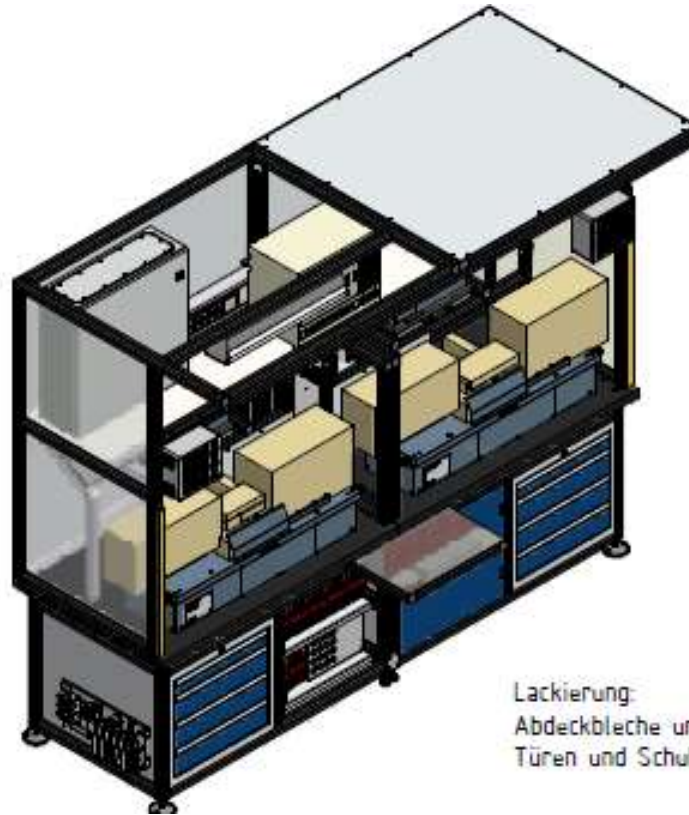

Lackierung:
Abdeckbleche und Schubladenkorpus RAL 7035 Lichtgrau
Türen und Schubladenfronten RAL 5019 Capriblau